



Official Certification Map and Instructions

Where

San Clara Fairgrounds 344 Tully Rd Santa Clara CA. 95111

Map and directions attached. Make sure you make enough copies for your players and staff.

When

Certification will be Held on Saturday August 28, 2010.

Check Official certification schedule for you time are enclosed.

Parking Information

YOU ARE TO PARK IN LOT ON Monterey Rd. .

THE COST TO PARK WILL BE \$5.00 PER CAR, 15.00 FOR BUSES AND 10.00
PER CAMPER.

**THERE WILL BE NO TAIL GATING ALLOWED AT
ANY POP WARNER EVENT.**



Driving Directions To The Fairgrounds 344 Tully Road

From Highway 101

Exit Highway 101 at Tully Road. Travel west on Tully Road for 1.5 miles. When you cross 10th Street, merge left. Make a "U" turn at 7th Street.

From Highway 280

Exit Highway 280 at 10th Street. Turn right. Travel South on 10th Street to Tully Road. Turn Right on Tully Road, merge left and make a "U" turn at 7th Street.

From Highway 880

From Highway 880, connect to Highway 101 Southbound. (The sign will read Los Angeles) Follow the Highway 101 directions above.

From Highway 680

Exit highway 680 at the Highway 101 Junction. Take the Los Angeles Ramp for Highway 101 Southbound. Stay to your right at all times. The right lane is the exit lane for Tully Road Westbound. Follow the directions above for Highway 101.

From Highway 87

Exit Highway 87 at Curtner Avenue. Travel East on Curtner Avenue. Once you cross Monterey Road, the streetname changes to Tully Road. The fairgrounds will be on the right hand side of the road.

From Highway 17

From Highway 17, connect to Highway 280 Southbound. (The sign will read Downtown San Jose) Follow the directions above for Highway 280.

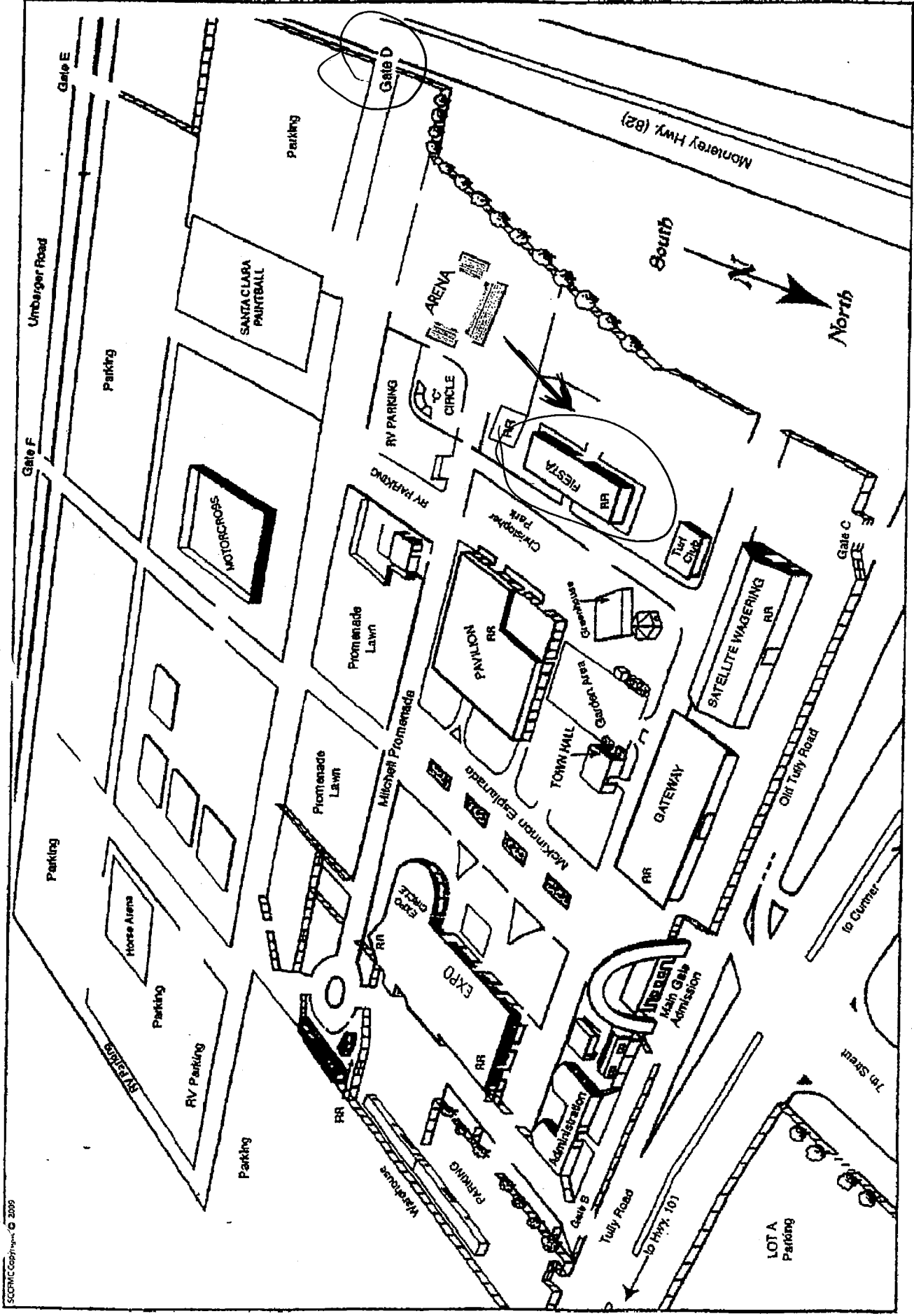

SANTA CLARA COUNTY FAIRGROUNDS

344 TULLY RD. SAN JOSE CA 95111

WWW.THEFAIRGROUNDS.ORG

← 140 FT →

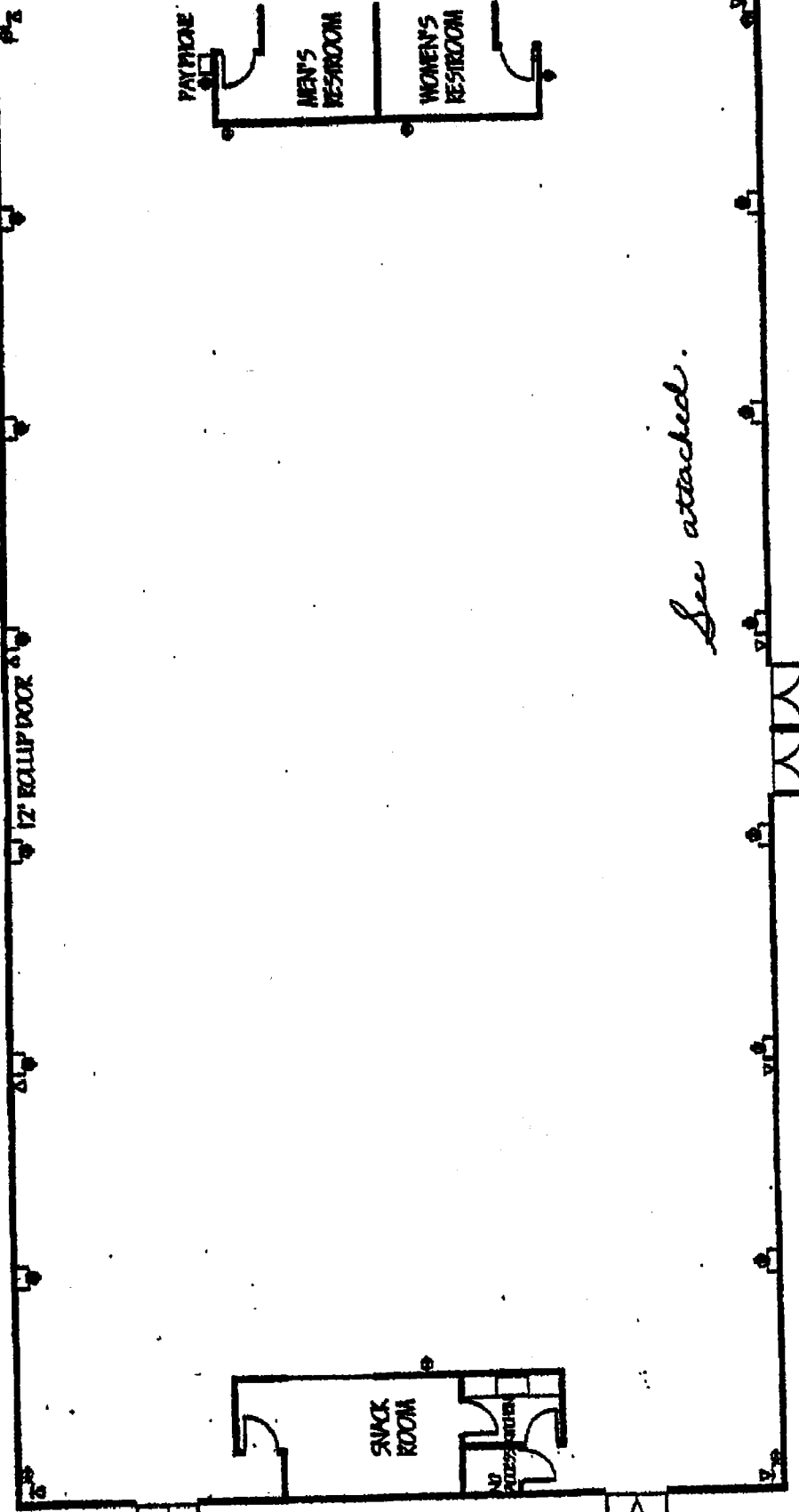

← 70 FT →

See attached.

QUESSING
 10 FT EACH END FOR
 SNACK & BATHROOMS

TURN ON PRIOR TO EVENT (1HR)

HEAT LIGHTS

CLEAN & STOCK RESTROOMS OPEN/CLEAN OUTSIDE RESTROOMS

RESTROOM ATTND HOURS: _____

SPECIAL INSTRUCTIONS: PARKING TO BE

CONTROLLED BY LICENSEE/MONTEREY GATE

REPORT TO INTERIM: _____

FIESTA HALL SET-UP